

Hair clipper set

User's manual

EN



SENCOR®

SHP 6201RD

Prior to using this appliance, please read the user's manual thoroughly, even in cases, when one has already familiarised themselves with previous use of similar types of appliances. Only use the appliance in the manner described in this user's manual. Keep this user's manual in a safe place where it can be easily retrieved for future use. In the event that you hand this appliance over to somebody else, make sure to also include this user's manual.

Carefully unpack the hair clipper and take care not to throw away any part of the packaging before you find all its parts. We recommend saving the original cardboard box, packaging material, purchase receipt and responsibility statement of the vendor or warranty card for at least the duration of the legal liability for unsatisfactory performance or quality. In the event of transportation, we recommend that you pack the appliance in the original box from the manufacturer.

OBSAH

IMPORTANT SAFETY INSTRUCTIONS	3
PURPOSE OF USE	14
CHARGING THE HAIR CLIPPER	14
EXTERNAL POWER SOURCE	14
DIRECT DRIVE TECHNOLOGY	15
ATTACHING AND REMOVING ATTACHMENTS	15
SETTING THE CLIPPING HEIGHT USING COMB ATTACHMENTS	16
TURNING THE HAIR CLIPPER ON AND OFF	16
SHAVING AND STYLING BEARDS	17
SMOOTHING OR REPAIRING BEARD CUTS	17
CLIPPING HAIR	18
TRIMMING NOSE AND EAR HAIR	18
CLEANING AND MAINTENANCE	18
STORAGE	20
TECHNICAL SPECIFICATIONS	20
EXPLANATION OF TECHNICAL TERMINOLOGY	20
DISPOSAL OF USED BATTERIES	21
INSTRUCTIONS AND INFORMATION REGARDING THE DISPOSAL OF USED PACKAGING MATERIALS	21
DISPOSAL OF USED ELECTRICAL AND ELECTRONIC EQUIPMENT	21

IMPORTANT SAFETY INSTRUCTIONS

General warnings

- Children must not use this appliance or play with it. Keep this appliance and its power cord out of reach of children.
- This appliance may be used by persons with physical or mental impairments or by inexperienced persons, if they are properly supervised or have been informed about how to use the product in a safe manner and understand the potential dangers.

Electrical safety

- Do not disconnect the power adapter from the power socket by pulling on the power cord. This could damage the power adapter or the power socket. Disconnect the power adapter from the power socket by pulling on the plug.

- Do not place the power cord of the power adapter over sharp objects. Make sure that the power cord does not hang over the edge of a table and that it is not touching a heated surface.

**Attention:**

The hair clipper must only be used with the original power adapter that came with it. In order to avoid a dangerous situation arising, never use a different type of power adapter.

- Never use the power adapter supplied with this hair clipper for any other purposes.
- Keep the power adapter and its power cord dry.
- Do not wind the power cord of the power adapter around the handle of the hair clipper.
- If the power cord of the power adapter is damaged, it must be replaced by the manufacturer, its service technician or by

a similarly qualified person, as this will prevent a dangerous situation from arising.

- Do not connect and disconnect the power adapter cord to and from the power socket with wet hands.
- Before connecting the power adapter to a power socket, check that the voltage on its rating label corresponds to the voltage in the power socket to which you wish to connect it. Do not use an extension cord.
- Store, charge and use the hair clipper at an ambient temperature of 15 to 35 °C. Do not charge the hair clipper for longer than is necessary for it to fully charge. Once it is charged, disconnect it from the power socket.
- Do not expose the hair clipper to temperatures higher than 50 °C. Otherwise, the built-in battery could be damaged.
- The hair clipper is equipped with a built-in long-life battery that can only be removed from the hair clipper at a professional service

centre. Never attempt to remove it from the hair clipper yourself.

**Warning:**

Never disassemble the hair clipper for the purpose of removing the battery. Never short circuit the hair clipper or throw it into a fire. Incorrect use, risks releasing toxic substances or causing a fire or explosion.

- Do not charge, use or store the hair clipper or leave it lying in a bathroom or in locations where it could fall into a bath, wash basin or other containers filled with water.
- In the event that the hair clipper falls into water, under no condition reach for it, rather, immediately disconnect the power adapter from the power socket. Never use a hair clipper or power adapter that was submerged in water. Hand it over to an authorised service centre for inspection.



Warning:

Do not use the hair clipper in the bath or shower. Do not clean it under a water tap, do not spray it with water or any other liquid or submerge it in water or any other liquid.

Safety during use

- This hair clipper is intended for home use only and is designed for cutting human hair, beards and nose and ear hair. The hair clipper is not intended for commercial purposes or for trimming animal fur.
- Only use the hair clipper on dry clean hair, beards or nose and ear hair. Do not use it on wet or just washed hair or on beards on which a shaving foam or gel, etc. is applied.
- Use the hair clipper and the individual clipper and comb attachments in accordance with the instructions contained in this user's manual.

- Use only the original accessories supplied with this hair clipper.
- The hair clipper and its power adapter must only be used in indoor areas. Do not use it outdoors.
- Do not use the hair clipper in rooms where aerosol sprays are used or where oxygen is administered.
- Do not expose the hair clipper and its accessories to the outdoor environment, extreme temperatures, direct sunlight, excessive humidity or excessively dusty environments.
- Do not place the hair clipper and its accessories near heaters, open fires or other sources of heat.

**Warning:**

Keep the hair clipper dry.

- Before every use, check the clipper and comb attachments for damage. Never use a hair

clipper with a damaged clipper or comb attachment.

- The hair clipper may heat up during use or when it is charged. This is a completely normal event.
- Keep the hair clipper at a safe distance from eyes.
- Never insert the nose and ear hair trimmer attachment deeper than 5 mm into the nose or ear.
- Always turn off the hair clipper and disconnect it from the power socket when not using it, when leaving it without supervision and before attaching, removing or replacing attachments and before cleaning, maintenance or storage. Store the hair clipper and its power adapter in a dry environment.
- Keep the hair clipper clean. Perform cleaning and maintenance according to the instructions in chapter Cleaning and maintenance.
- Do not perform any maintenance on the hair clipper other than cleaning the individual

parts of the hair clipper as described in chapter Cleaning and maintenance.

- Never use a hair clipper or power adapter that is damaged in any way.
- Do not use the hair clipper if it has fallen on the floor, if it was submerged in water, if it is not functioning correctly or if it is damaged in any other way.
- In order to prevent a hazardous situation arising, do not repair the hair clipper or any of its accessories yourself or modify it in any way. For all repairs, contact an authorised service centre. By tampering with the product you risk voiding your legal rights arising from unsatisfactory performance or quality warranty.

Hair clipper set

SHP 6201RD

EN

DESCRIPTION OF THE HAIR CLIPPER AND ITS ACCESSORIES

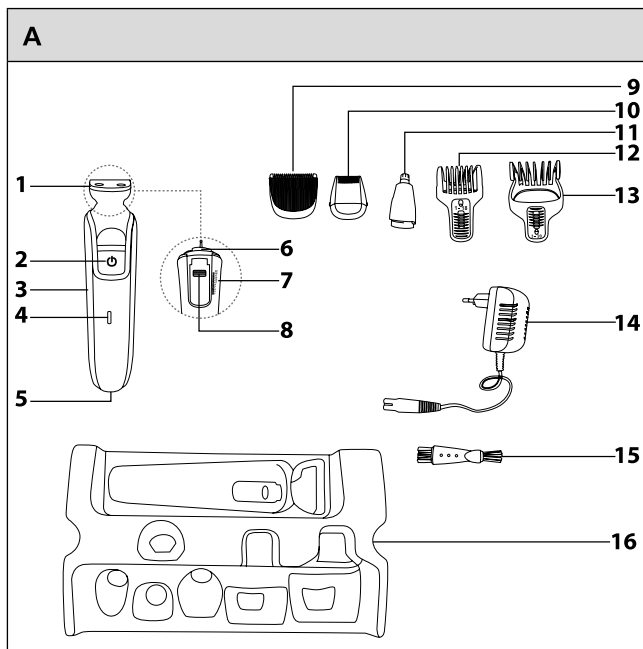

Hair clipper set

SHP 6201RD

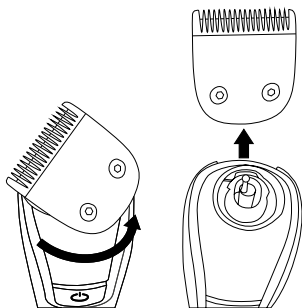
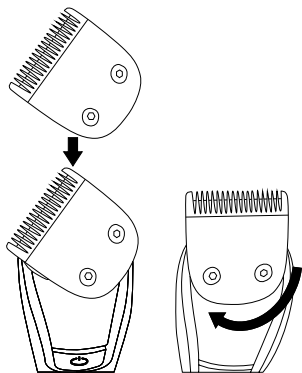
B**C**

Hair clipper set

SHP 6201RD

EN

D

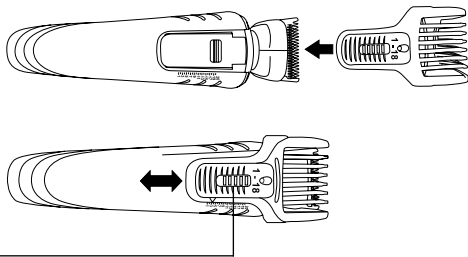

- A1** Beard shaving attachment, blade width 32mm
- A2** Button for turning the hair clipper on and off
- A3** Ergonomically-shaped handle
- A4** LED charging indicator
- A5** Power adapter connection socket
- A6** Attachment mounting head
- A7** Scale
- A8** Clipper bar
- A9** Hair clipper attachment, blade width 41 mm
- A10** Fine shaving attachment
- A11** Nose and ear hair trimmer attachment
- A12** Beard shaving comb attachment
Mounted on the beard shaving attachment and enables cutting heights of 1 - 8 mm.
- A13** Hair clipper comb attachment
Mounted on the hair clipper attachment and enables cutting heights of 3 - 20 mm.
- A14** Power adapter
- A15** Cleaning brush
- A16** Hair clipper and accessory stand
- D1** Clipping height regulator

PURPOSE OF USE

- The hair clipper is suitable for cutting dry or lightly dampened hair or beards. The hair clipper is not intended for cutting freshly washed hair, clipping synthetic hair or animal fur. The hair clipper is intended for domestic use and is not intended for business activities or other professional areas of use.

CHARGING THE HAIR CLIPPER

- This hair clipper can be powered both from an external as well as the internal power source. Before first use or after a long period of non-use, allow the hair clipper to first fully charge according to the instructions contained in subchapter Internal power source.

EXTERNAL POWER SOURCE

- To power the hair clipper from an external power source, only use the original power adapter **A14** (output 5 V, 600 mA, 3W).
- Check that the hair clipper is turned off and connect the connector of the power adapter **A14** to the socket **A5**. Insert the power adapter plug **A14** into a power socket. After connecting to a power socket, the LED indicator **A4** will be lit.
- If the hair clipper is powered from a power socket, allow it to cool down after 30 minutes of continuous operation.
- When you have finished using the hair clipper, always turn it off and disconnect it from the power socket. First, pull the power adapter plug **A14** out of the power socket and only then disconnect the power adapter's connector from the socket **A5**.

INTERNAL POWER SOURCE

- The hair clipper is equipped with a built-in Ni-MH battery (2.4 V , 600 mAh), which serves as an internal power source and enables cordless operation of the hair clipper.
- Before first using the hair clipper, regardless of the external power source, allow the built-in battery to fully recharge. To charge the battery, connect the hair clipper to an external power source according to the instructions contained in the preceding subchapter. Only use the original power adapter **A14**.
- The built-in battery will start charging after connecting the hair clipper to a power socket. The red lit LED indicator **A4** signals that the battery is charging. It takes approximately 8 hours to fully charge the battery. The LED charging indicator **A4** does not change colour after the battery is charged and remains lit.

- At the end of the charging process, disconnect the power adapter plug **A14** from the power socket and then disconnect the power adapter's connector **A14** from the socket **A5**. When the hair clipper is disconnected from the external power source, the LED indicator **A4** will turn off.



Attention:

Do not leave the hair clipper connected to the external power source for longer than is necessary to charge it.

- A fully charged battery will provide approximately 45 minutes of cordless operation. Then it is necessary to charge the battery again.
- Recommendations for achieving the longest possible battery lifetime:
 - In order for the built-in battery to serve you as long as possible, charge, use and store the hair clipper in a dry environment at an ambient temperature of 15–35 °C. Lower or higher temperatures have a negative impact on the lifespan of the battery.
 - Do not wait for the battery to become completely flat. It is better to charge the battery before it is completely flat.
 - When the hair clipper is not used for an extended period of time, charge it at least once every 6 months.

DIRECT DRIVE TECHNOLOGY

- The hair clipper is equipped with **DIRECT DRIVE** technology, which enables the hair clipper to be used immediately upon being connected to the mains power socket even when the battery is completely flat. Therefore, it is not necessary to wait for a minimum charge.

ATTACHING AND REMOVING ATTACHMENTS

CLIPPER ATTACHMENT

- Before attaching, removing or replacing the attachments, turn the hair clipper off and disconnect it from the power socket.
- To remove the clipper attachment **A1**, turn it anticlockwise and remove it from the mounting head **A6** by pulling upwards, see figure **B**. At the same time, hold handle **A3** in such a way that button **A2** is not pressed. In the same way, remove attachments **A9**, **A10** or **A11**.

Hair clipper set

SHP 6201RD

- To mount attachment **A1** on to the mounting head **A6** proceed according to figure **C**. The clip on the underside of attachment **A1**, must slide into the locking grooves in the mounting head **A6** and then it is necessary to turn the attachment clockwise. This is indicated by a click. In the same way, mount attachments **A9**, **A10** or **A11**.

COMB ATTACHMENTS

- To mount the comb attachment **A12** to hair clipper attachment **A1**, proceed according to figure **D**. First slide the comb attachment **A12** on to the clipper bar **A8** until you hear a click. Then press the clipping height regulator **D1** and push downwards. In the same way, mount attachment **A13**.
- To remove the comb attachment **A12**, press the clipping height regulator **D1** and pull upwards to remove it. In the same way, remove attachment **A13**.

SETTING THE CLIPPING HEIGHT USING COMB ATTACHMENTS

- Comb attachment **A12** or **A13** enable various clipping heights to be set. The cutting height is set by sliding the comb attachment that is mounted on the respective hair clipper attachment up and down. The attachments enable the following cutting heights:
Attachment **A12**: 1 - 8 mm.
Attachment **A13**: 3 - 20 mm.
- The set position is marked by an arrow on the attachment.

USING THE HAIR CLIPPER

- Select an appropriate type of attachment and mount it on the hair clipper.
- Before every use, check the hair clipper, shaving or comb attachment for damage. Never use a hair clipper with a damaged attachment.
- Only use the hair clipper on dry clean hair, beards or nose and ear hair. Do not use it on wet or just washed hair or beards on which a shaving foam or gel, etc. is applied.
- Before starting any styling of hair, beards or nose and ear hair, acquaint yourself with the operating instructions.

TURNING THE HAIR CLIPPER ON AND OFF

- Turn the hair clipper on and off using button **A2**.

**Attention:**

The cutting blades will cut off all hair, beards or nose and ear hair that comes into contact with them, therefore be especially careful when handling the hair clipper while it is running.

- When you have finished using it, always turn the hair clipper off by pressing button **A2** and disconnect it from the power socket if it was powered from a mains power socket. Then clean it out according to the instructions in chapter Cleaning and maintenance.

SHAVING AND STYLING BEARDS

- **Short beards** - For shaving and styling short beards, use just the attachment **A1**.
- When cutting beards, hold the attachment **A1** at a 90° angle to the skin and make short vertical strokes. Using the hair clipper, exert gentle pressure on the skin while using your other hand to tension the skin so that the beard is upright. On harder beards, it may be necessary to exert more pressure.
- Be careful when styling because attachment **A1** will remove every whisker that it comes into contact with. Hold the hair clipper in such a way that the attachment is in contact with the skin. Do not exert too much pressure on the skin. Style the beard on the required parts of the face using light and slow strokes until the required beard shape is achieved.
- **Longer beards** - for cutting longer beards, use attachment **A1** with comb attachment **A12**. The cutting height can be adjusted using the cutting height regulator **D1** in the range 1 - 18 mm. If you are using the hair clipper for the first time, we recommend setting the maximum cutting height. In order to achieve an evenly trimmed beard, keep the comb attachment **A12** in contact with the skin and slowly move the hair clipper counter to the growth direction of the beard from the bottom up. Do not exert too much pressure and do attempt to rush the process too much. Please remember that the comb attachment **A12** must constantly remain in contact with the skin to ensure an even cut.
- Regularly remove whiskers that have accumulated in attachment **A12**. Turn the hair clipper off prior to removing the beard hair.

SMOOTHING OR REPAIRING BEARD CUTS

- To smooth out or repair a beard cut, use attachment **A10**. The attachment consists of a flexible shaving foil and is intended only for the final shave in the area of the contours around moustaches, goatees and sideburns.

CLIPPING HAIR

- **Short hair** - for clipping short hair, use only attachment **A9**. Attachment **A9** is suitable primarily for trimming up sideburns and the ear line and the nape of the neck. When trimming the ear line, hold the hair clipper so that the blade of the attachment points downwards ensuring that only the cutting blades are in contact with the hair. When trimming the line at the nape of the neck, hold the hair clipper so that the blade of the attachment points downwards. Touch the skin with the cutting blade only very lightly.
- **Longer hair** - for clipping longer hair, use attachment **A9** with comb attachment **A13**. First comb the hair. Clip the hair using slow repeat strokes and clip small hair sections. It is recommended to start with a larger clipping range and to gradually reduce it. The cutting height can be adjusted using the cutting height regulator **D1** in the range 3 - 20 mm.



Attention:

Attachment **A9** will cut off all hair that comes into contact with it, therefore be especially careful when handling the hair clipper while it is running.

TRIMMING NOSE AND EAR HAIR

- To trim hair inside the nose and ears, use attachment **A11**. Slowly place attachment **A11** against the nasal or ear opening. Carefully move attachment **A11** in and out of the nasal or ear opening while at the same rotating it until the required hair is removed.



Attention:

Never insert attachment **A11** deeper than 5 mm into the nose or ear.

CLEANING AND MAINTENANCE

- Before you start cleaning the hair clipper, turn it off and disconnect it from the power socket.
- Regular cleaning after every use will ensure its proper operation.



Attention:

This hair clipper is not designed to be washed under a water tap. Do not spray the hair clipper or its power adapter **A14** with water or any other liquid or submerge it in water or any other liquid.

- If the comb attachment is attached to the hair clipper attachment, remove it. Remove the attachment that is attached to the handle **A3**.
- Using brush **A15**, remove any hair, beard or whisker remains from all the other attachments **A1**, **A9**, **A8**, **A9**, **A10**, **A11**, **A12** and **A13**. Then clean the mounting head **A6** using the brush **A15**. Make sure that hair and beard remains or other material do not accumulate on the hair clipper attachment or in the mounting head.



Attention:

The cutting blades on the attachments are sharp, pay increased attention when handling them.

- Carefully blow out the shaving foil of attachment **A11** or gently tap on the edge of the attachment so that all beard remains are removed from the shaving foil.
- Comb attachments **A12** and **A13** can be washed under lukewarm running water. After washing the attachment, carefully wipe it with a soft, dry cloth and then allow it to dry naturally. Do not wash attachments **A1**, **A9**, **A10** and **A11** under running water.
- The hair clipper handle **A3** can be cleaned using a clean dry cloth. In the event that it is very dirty, you can use a lightly dampened cloth. Then thoroughly wipe the cleaned surface dry.
- After cleaning it, attach the required type of attachment back on to the handle **A3**. Make sure that the attachment is completely dry before attaching it.
- To clean the adapter **A14**, use a clean, dry cloth.
- For cleaning, do not use brushes with hard bristles, cleaning products with an abrasive effect, solvents, etc. Otherwise, the cleaned surface may be damaged.

REPLACEMENT OF ATTACHMENTS

- In the event that the cutting blade or shaving razors are worn out, replace the respective attachment with a new one.
- Replacement attachments are available from you vendor both in online and brick&mortar stores.

STORAGE

- When you have finished using it, you may store the hair clipper with all its accessories in the stand **A16**. Before placing the hair clipper into the stand **A16**, make sure that the stand **A16** is located on a stable horizontal surface.

TECHNICAL SPECIFICATIONS

Hair clipper

Built-in battery	Ni-MH, 2.4 V, 600 mAh
Output	3 V, 1 A
Dimensions (width × depth × height)	150 × 39 × 41 mm
Weight	119 g
Noise level	68 dB(A)

Power adapter

Rated voltage	100–240 V AC
Rated frequency	50/60 Hz
Output	3 V/DC, 1 A, 3 W

The declared noise emission level of the appliance is 68 dB(A), which represents a level A of acoustic power with respect to a reference acoustic power of 1 pW.

EXPLANATION OF TECHNICAL TERMINOLOGY

Safety class for electrical shock protection:

IP20 – The appliance is constructed in such a way that it is not possible for any dangerous live parts of the appliance to come into contact with the human body and at the same time the appliance is protected against the damaging effects of water that could enter into the appliance.

Changes to text and technical parameters are reserved.

DISPOSAL OF USED BATTERIES

Prior to handing over the product at a specialised collection facility, it is necessary to ensure that the built-in battery is removed. Before removing the battery, disconnect the hair clipper from the power socket and allow it to fully discharge. Then take the cutting unit off the handle **A3** and using a flat screwdriver, remove the front cover of the handle **A3**. Cut off the wires and remove the battery. Battery removal may also be performed at an authorised service centre. In the event that the product has been disassembled for the purpose of ecological disposal then it must not be reassembled.



This symbol indicates that used batteries do not belong in ordinary municipal waste. Hand over used batteries to designated collection points for proper disposal. Correct disposal of batteries will help prevent negative impacts on the environment and human health.

Disposal in other countries outside the European Union.

This symbol is valid in the European Union. If you wish to dispose of used batteries, request the necessary information about the correct disposal method from the local authorities or from your vendor.

INSTRUCTIONS AND INFORMATION REGARDING THE DISPOSAL OF USED PACKAGING MATERIALS

Dispose of used packaging material at a site designated for waste in your municipality.

DISPOSAL OF USED ELECTRICAL AND ELECTRONIC EQUIPMENT



This symbol on products or original documents means that used electric or electronic products must not be added to ordinary municipal waste. For proper disposal, renewal and recycling hand over these appliances to determined collection points. Alternatively, in some European Union states or other European countries you may return your appliances to the local retailer when buying an equivalent new appliance.

Correct disposal of this product helps save valuable natural resources and prevents potential negative effects on the environment and human health, which could result from improper waste disposal. Ask your local authorities or collection facility for more details.

In accordance with national regulations penalties may be imposed for the incorrect disposal of this type of waste.

Hair clipper set

SHP 6201RD

For business entities in European Union states

If you want to dispose of electric or electronic appliances, ask your retailer or supplier for the necessary information.

Disposal in other countries outside the European Union.

This symbol is valid in the European Union. If you wish to dispose of this product, request the necessary information about the correct disposal method from the local council or from your retailer.



This product meets all the basic requirements of EU directives related to it